

Model: VAC-150-G/P  
ILLUSTRATION 3:  
14 inch BLOWER ASSEMBLY

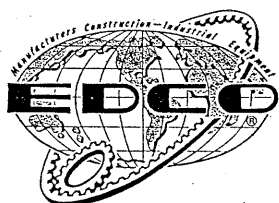
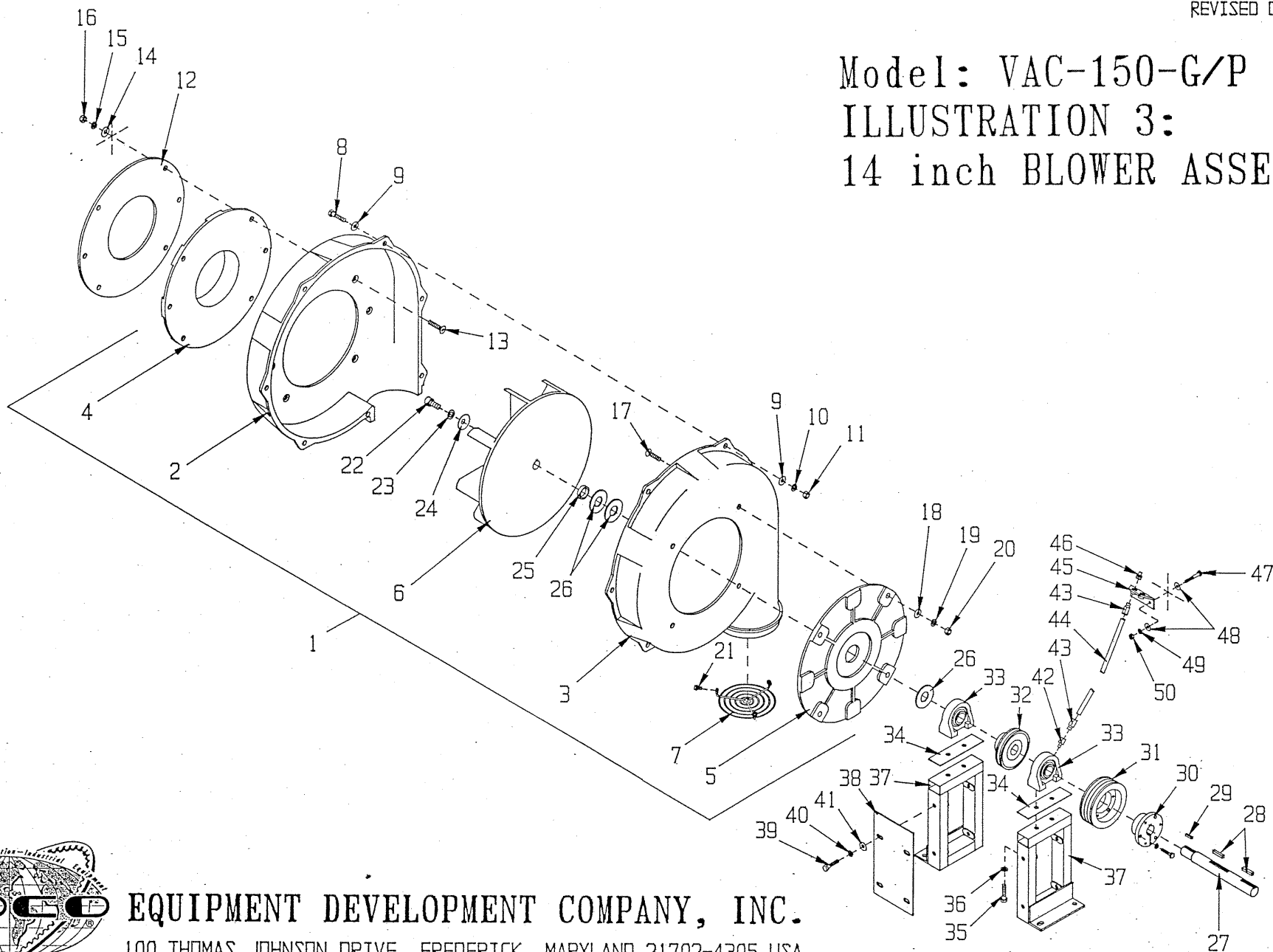

**EQUIPMENT DEVELOPMENT COMPANY, INC.**

100 THOMAS JOHNSON DRIVE, FREDERICK, MARYLAND 21702-4305 USA

PHONE (301)663-1600

TOLL FREE 1-800-638-3326

FAX (301)663-1607

FAX FREE 1-800-447-3326

## PARTS LISTING - ILLUSTRATION 3: 14 inch BLOWER ASSEMBLY

Item #	Part #	Description	Qty.
1	C65370	Blower Housing & Wheel (Includes Items 2 thru 7)	1
2	C65371	Blower Housing, Inlet Side	1
3	C65372	Blower Housing, Outlet Side	1
4	C65373	Blower Inlet Pad 6"	1
5	C65374	Blower Outlet Pad	1
6	C65375	Blower Wheel, 14 x 3-1/4, B.C. w/ 7/8" Bore	1
7	C65376	Blower Outlet Guard	1
8	10068	Screw, Cap, 3/8-16 x 1-1/2	7
9	10025	Washer, Flat 3/8	14
10	10811	Washer, Lock 3/8	7
11	10404	Nut 3/8-16	7
12	C65377	Blower Adapter Plate	1
13	10164	Screw, Flat Head Skt. 3/8-16 x 1-3/4	6
14	10025	Washer, Flat 3/8	6
15	10811	Washer, Lock 3/8	6
16	10404	Nut 3/8-16	6
17	10165	Screw, Flat Head Skt. 3/8-16 x 1-1/2	4
18	10025	Washer, Flat 3/8	4
19	10811	Washer, Lock 3/8	4
20	10404	Nut 3/8-16	4
21	10846	Screw, Self-Tap Hex Washer 1/4-20 x 1/2	3
22	10419	Screw, Socket Head Cap 1/2-13 x 1	1
23	10420	Washer, Lock 1/2 Heavy Duty	1
24	10426	Washer, Spring 1/2"ID x 3/64"Thk	1
25	C65378	Spacer, 1-1/4"OD x 1"ID x 5/16"Thk	1
26	10866	Washer, Hard Fiber 2-1/4"OD x 1"ID x 1/8"Thk	3
27	C65315	Jackshaft, Blower	1
28	10305	Key 1/4 Sq. x 1-1/4	2
29	10142	Key 3/16 Sq. x 3/4	1
30	10043	Bushing, Sheave SDS x 1"Bore	1
31	10554	Sheave 4.5"OD x 3Gr.3V x SDS	1
32	C65331	Sheave 3.8"OD x 1Gr.B x 1"Bore	1
33	50222	Bearing, Ball 1" Tapped Block	2
34		Shim, Bearing	2
	C65313	1/16" Thick	
	C65312	1/8" Thick	
	C65311	3/16" Thick	
35	10068	Screw, Cap 3/8-16 x 1-1/2	4
36	10811	Washer, Lock 3/8	4
37	C65314	Tower, Bearing	2
38	C65310	Support Plate, Bearing Tower	2
39	10342	Screw, Cap 5/16-18 x 1-1/2	8
40	10801	Washer, Lock 5/16	8
41	10213	Washer, Flat 5/16	8
42	50541	Adapter, Grease Fitting 1/8FPT x 1/4-28	2
43	10599	Fitting, Push-In 1/4 Tube x 1/8MPT Brass	4
44	C65309	Tubing, Nylon 1/4"OD x 18" L.	2
45	C65308	Bracket, Grease Fitting	1
46	10953	Fitting, Grease 1/8 NPT Straight	2
47	10315	Screw, Cap 1/4-20 x 1-1/2	2
48	10602	Washer, Flat 1/4	4
49	10038	Washer, Lock 1/4	2
50	10013	Nut 1/4-20	2