

Model ASB-14 AIR MOTOR ASSEMBLY

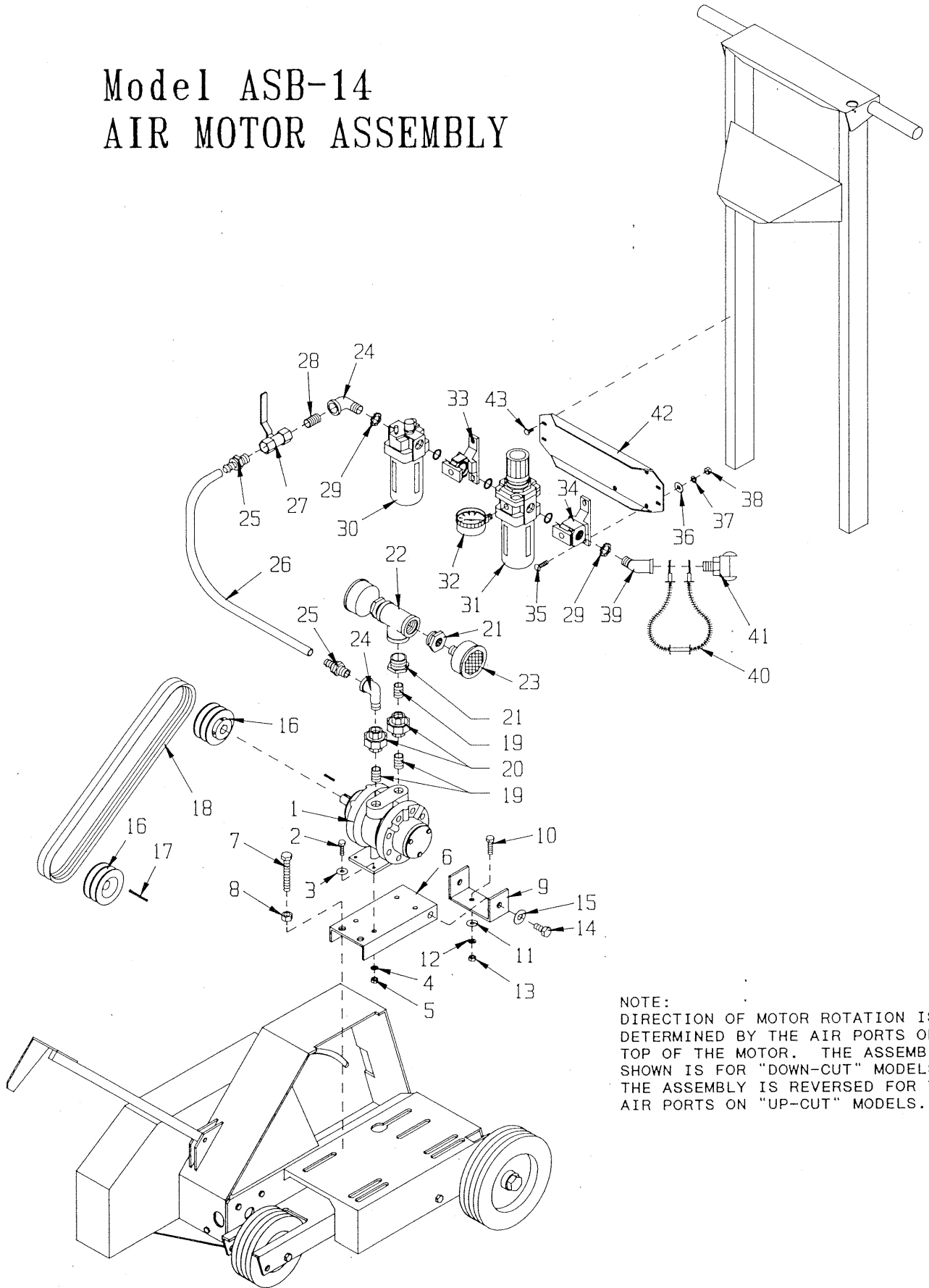

PARTS LISTING FOR MODEL ASB-14 AIR MOTOR ASSEMBLY			
Item #	Part #	Description	Qty.
1	80050	Motor, Air, 5 HP	1
2	10606	Screw, Cap 5/16-18 x 1-1/4	4
3	10213	Washer, Flat 5/16	4
4	10801	Washer, Lock 5/16	4
5	10054	Nut 5/16-18	4
6	80065	Mount, Air Motor	1
7	10340	Bolt, Tap 1/2-13 x 3 (Full Thread)	2
8	10417	Nut 1/2-13	2
9	80066	Bracket, Motor Mount	1
10	10309	Screw, Cap 3/8-24 x 1-1/4	2
11	10025	Washer, Flat 3/8	2
12	10811	Washer, Lock 3/8	2
13	10014	Nut 3/8-24	2
14	10914	Screw, Cap 1/2-13 x 1	2
15	10312	Washer, Flat 1/2	2
16	80016	Sheave 3"OD x 2Gr.B x 3/4"Bore	2
17	10020	Key 3/16" Sq. x 1-7/8	1
18	10251	Belt BP-34	2
19	80059	Pipe Nipple, Close 1/2 NPT (Galv.)	3
20	80060	Pipe Union 1/2 NPT (Galv.)	2
21	80057	Bushing, Hex 1 x 1/2 NPT (Galv.)	3
22	80056	Pipe Tee, Female 1"NPT (Galv.)	1
23	80055	Muffler, 1/2 NPT	2
24	10724	Elbow, Street 1/2 NPT x 90°(Black)	2
25	80061	Barb, Push-On 1/2 Hose x 1/2 MPT	2
26	80063	Hose, Push-On 1/2"ID x 17"LG	1
27	10711	Valve, Ball 1/2 FPT	1
28	10796	Pipe Nipple 1/2NPT x 1-1/2"(Black)	1
29	10790	Conduit Lock Nut 1/2 NP	2
30	80071	Lubricator, 1/2 NPT NAL4000-N04	1
31	80070	Filter/Regulator 1/2 NPT NAW4000-N04	1
32	C90207	Gauge, Air Pressure, Side Stem	1
33	80072	Bracket, T-Type, Y40T	1
34	80073	Bracket, T-Type Adaptor, NE40T-N04	1
35	10819	Bolt, Carriage 5/18-18 x 1	4
36	10213	Washer, Flat 5/16	4
37	10801	Washer, Lock 5/16	4
38	10054	Nut 5/16-18	4
39	10734	Elbow, Street 1/2 NPT x 45° (Black)	1
40	63040	Cable, "Whipchek" Safety 1/8 x20-1/4	1
41	80075	Coupler, Air Hose, 1/2 MPT	1
42	80074	Bracket, F.R.L. Mounting	1
43	10846	Screw, S.T. Hex Washer 1/4-20 x 1/2	4

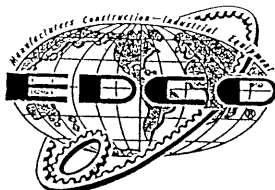

EQUIPMENT DEVELOPMENT COMPANY, INC.

100 THOMAS JOHNSON DRIVE, FREDERICK, MARYLAND 21702-4305 USA

PHONE (301)663-1600

TOLL FREE 1-800-638-3326

FAX (301)663-1607

FAX FREE 1-800-447-3326